

Bug Bounty Visma Scanner - Start guide

Step 1:

Create an account on vismaonline stage environment by register a student company:

<https://admin.stage.vismaonline.com/Customer/StudentSignup.aspx?uilang=en>

Training code: n4kb3

Register your student company

Step 1 of 2

This is where you create the company that you will use during your training. The next time you want to log in to your company, go to <http://www.vismaspcs.se> and select Log in. You log in using using the email address and password you chose below.

Training code: *

Your teacher will give you the training code

Your login

First name: *

Last name: *

Email address: *

Step 2:

Select both Program/service options (Visma Scanner + Visma eEkonomi) and press 'Save'

Register your student company

Visma Spcs Training license



Step 2 of 2	
Your school	Scanner Bug Bounty School
Your student company	
Company name	<input type="text" value="Jean Grey student company"/>
Program/service	Teacher (voluntary)
<input checked="" type="checkbox"/> Visma Scanner	<input type="text"/>
<input checked="" type="checkbox"/> Visma eEkonomi	<input type="text"/>
<input type="button" value="Save"/>	

You should then see this:

Student company created

Welcome to Visma Spcs!

You have been registered as a user. We have sent you an email in order to verify your email address. Click on the link in the email to log in.

Step 3:

Now you should get an email from do.not.reply@platform.stagaws.visma.com, click on the green button "Aktivera konto" to activate the account. (Check spam folder)

Hej Jean Grey,

Välkommen till Visma Online och tack för din registrering!

Klicka på länken nedan och följ instruktionerna för att aktivera ditt konto jean.grey@mailinator.com.

[Aktivera konto](#)

Denna länk upphör att gälla om 24 timmar och fungerar bara en gång. Om länken inte går att klicka på, kopiera och klistra in den i din webbläsare.

Vänliga hälsningar,
Visma



Step 4:

Enter a password for the account and click on the green button “Ändra lösenord” to proceed.

- Minimum 8 characters
- Minimum 1 capital letter
- Minimum 1 lowercase letter
- Minimum 1 numerical
- Minimum 1 special character

Visma Online

Ange ditt nya lösenord

Nytt lösenord

Bekräfta lösenord

Ändra lösenord

[Tillbaka till inloggningen](#)

VISMA

- ✓ Minst 8 tecken
- ✓ Minst 1 versal (stor bokstav)
- ✓ Minst 1 gemen (liten bokstav)
- ✓ Minst 1 numeriska
- ✓ Minst 1 specialtecken (t ex ! ?)

Click the green button “OK, jag har läst” to accept user terms and proceed.

Användarvillkor

Våra Användarvillkor har uppdaterats

Du är ansvarig för ditt användarkonto och hur det används. Detta inkluderar säkerheten, platsen och uppkopplingen för alla enheter som du använder. Skydda ditt lösenord eller andra säkerhets- och behörighetsuppgifter genom att hålla dem hemliga och konfidentiella. Du får inte dela ditt användarkonto med någon annan eller använda det på ett sätt som strider mot Användningsvillkoren.

www.visma.com/trust-centre/transparency-main/smb/service-information/terms-of-service

Användning av Vismas tjänster innebär behandling av dina användningsdata. Läs mer om hur Visma behandlar personuppgifter:

www.visma.com/trust-centre/transparency-main/smb/transparency/usage-data

OK, jag har läst

VISMA

Step 5:

After the account has been created proceed to download the Visma Scanner app from App Store or Play Store:

<https://play.google.com/store/apps/details?id=com.visma.blue&hl=en>

<https://apps.apple.com/us/app/visma-scanner/id564141518>

Step 6: (Note that these steps will also be the same for iOS but with slightly different UI)

Navigate to correct login page by following these following steps:

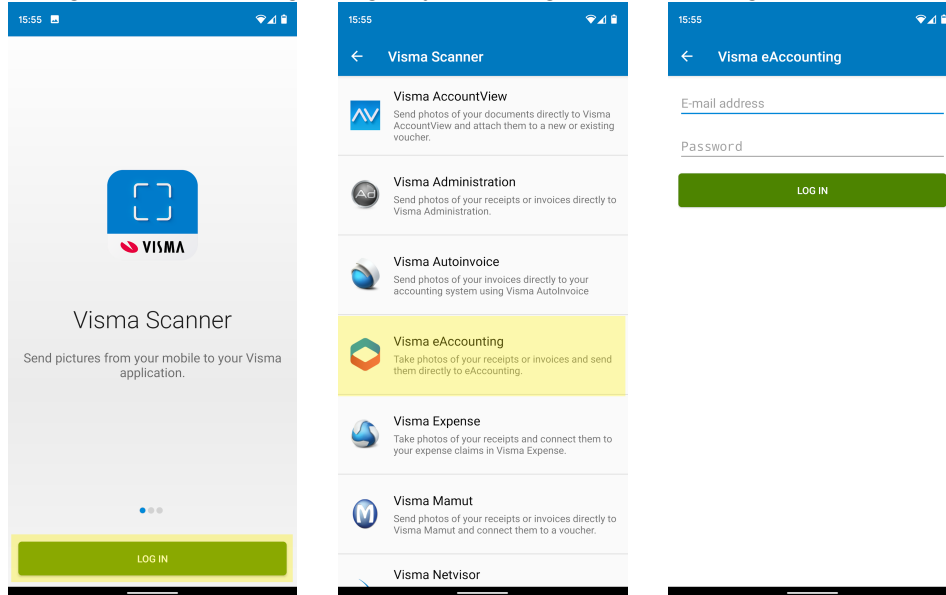

Step 7:

Tap the bottom left corner 5 times in a row (sometimes it will need to be tapped multiple times extra). This will open the environment selector. Please select STAGE.

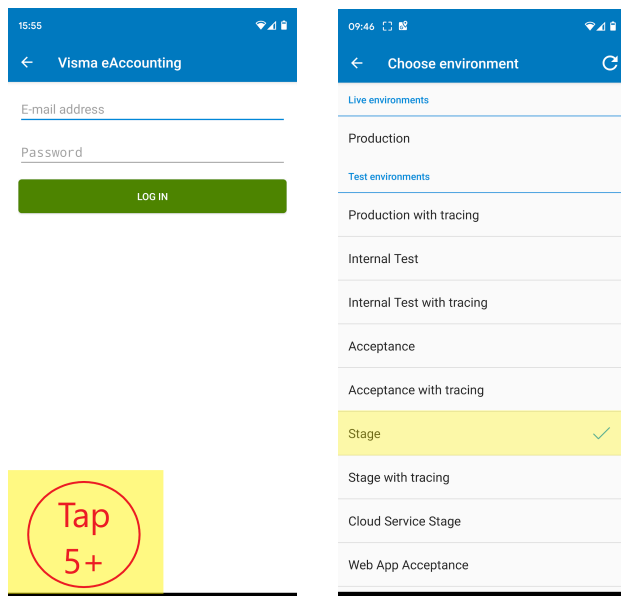

Step 8:

Enter the login credentials for the account you created in previous steps and press “Logga in”

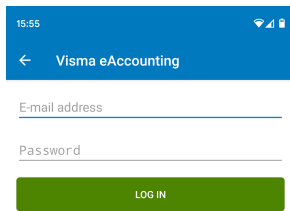

A screenshot of a mobile application's login screen. At the top, the status bar shows the time 15:55 and signal strength. Below the status bar is a blue header with a back arrow, the text "Visma eAccounting", and a search icon. The main area contains two input fields: "E-mail address" and "Password". At the bottom, there is a green button labeled "LOG IN".

Step 9:

Congratulations you are now logged in to the Visma Scanner app!

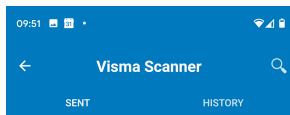

A screenshot of the Visma Scanner app's home screen. The status bar shows the time 09:51. The blue header contains a back arrow, the text "Visma Scanner", and a search icon. Below the header are two tabs: "SENT" and "HISTORY". The main area is mostly empty, with a document icon and the text "There are no documents." centered on the screen.

There are no documents.



Scope for Bug Bounty

The scope of the bug bounty is the whole Visma Scanner app with the eAccounting integration and stage environment.

What is out of scope:

- Session invalidation issues (e.g. logout, password change, email change, role change, user deletion, etc)
- Private screen exposure in the app
- All environments except the staging environment are excluded from Bug bounty
- Stack traces from api calls
- Jailbroken devices is out of scope
- All options for login are out of scope, except eAccounting

Please note again that all the rest of the integrations, except eAccounting are out of scope for Bug Bounty. You will not be able to login to any other integration than eAccounting. Therefore make sure to select the eAccounting integration when login in, and also switch to stage environment (see instruction details in step 6 above).